

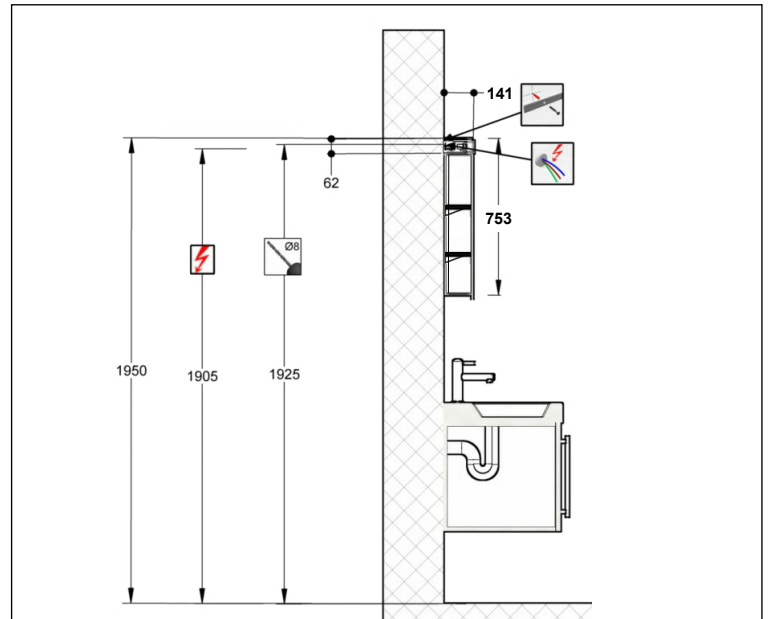

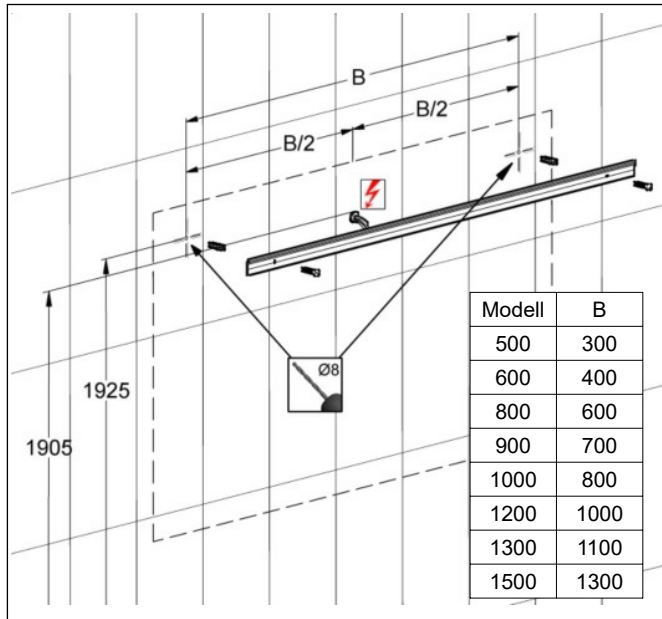

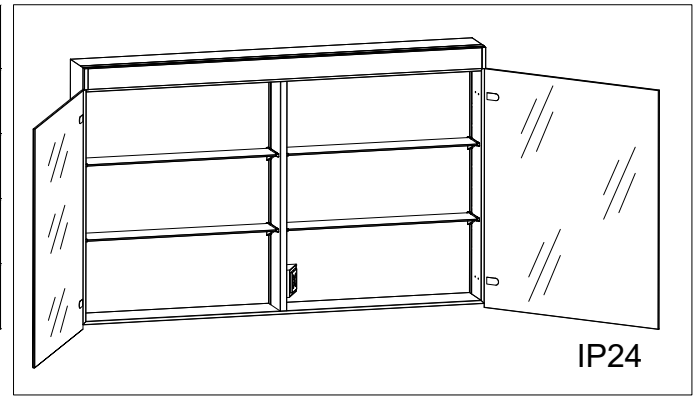





Massskizze / Montageanleitung Modico Rem.3 LED

Fiche de mesure / Instruction de montage Modico Rem.3 LED

Scheda misure / Istruzione di montaggio Modico Rem.3 LED

690309 Keller Art. Nr. 110403173	Modico Rem.3 LED 500/1T/BL Modico Rem.3 LED 500/1P/CG Modico Rem.3 LED 500/1P/CS	690315 Keller Art. Nr. 110403413	Modico Rem.3 LED 1000/2T Modico Rem.3 LED 1000/2P Modico Rem.3 LED 1000/2P
690310 Keller Art. Nr. 110403183	Modico Rem.3 LED 500/1T/BR Modico Rem.3 LED 500/1P/CD Modico Rem.3 LED 500/1P/CD	690316 Keller Art. Nr. 110403513	Modico Rem.3 LED 1200/2T Modico Rem.3 LED 1200/2P Modico Rem.3 LED 1200/2P
690311 Keller Art. Nr. 110403013	Modico Rem.3 LED 600/1T/BL Modico Rem.3 LED 600/1P/CG Modico Rem.3 LED 600/1P/CS	690317 Keller Art. Nr. 110403733	Modico Rem.3 LED 1300/2T Modico Rem.3 LED 1300/2P Modico Rem.3 LED 1300/2P
690312 Keller Art. Nr. 110403023	Modico Rem.3 LED 600/1T/BR Modico Rem.3 LED 600/1P/CD Modico Rem.3 LED 600/1P/CD	690319 Keller Art. Nr. 110403723	Modico Rem.3 LED 1300/3T Modico Rem.3 LED 1300/3T Modico Rem.3 LED 1300/3T
690313 Keller Art. Nr. 110403073	Modico Rem.3 LED 800/2T Modico Rem.3 LED 800/2P Modico Rem.3 LED 800/2P	690318 Keller Art. Nr. 110403813	Modico Rem.3 LED 1500/3T Modico Rem.3 LED 1500/3T Modico Rem.3 LED 1500/3T
690314 Keller Art. Nr. 110403313	Modico Rem.3 LED 900/2T Modico Rem.3 LED 900/2P Modico Rem.3 LED 900/2P		



Die Montage des Spiegelschranks muss durch einen Fachmann im Sanitärbereich erfolgen. Arbeiten an den elektrischen Installationen dürfen nur von autorisierten Fachleuten nach den örtlichen Vorschriften ausgeführt werden. Für nicht fachgerechte Installation wird jegliche Haftung abgelehnt. Räume mit Badewanne ① oder Dusche ① müssen mit einer FI-Schutzeinrichtung (RCD) I Δ n = 30mA gesichert sein. Bereich ② mindestens Schutzart IP X4. Bereich ② keine Steckdosen.

Le montage de l'armoire de toilette doit être effectué par un spécialiste autorisé en équipement sanitaire. Les travaux à l'installation électrique ne doivent pas être effectués que par des spécialistes autorisés selon les prescriptions locales. Si l'installation n'est pas faite par un expert nous déclinons toute responsabilité. Locaux avec baignoire ① ou douche ① doivent être protégés par un dispositif de protection FI (RCD) I Δ n = 30mA. Volume ② mind. degré de protection IP X4. Volume ② des prises électriques ne sont pas permises.

Il montaggio dell'armadietto da bagno deve essere eseguito da personale autorizzato del settore impianti sanitari. L'installazione elettrica deve essere eseguita da personale autorizzato secondo le norme vigenti del posto. Se l'installazione non viene eseguita dal personale autorizzato decliniamo ogni responsabilità. Ambienti con vasca da bagno ① o doccia ① devono essere protetti con un dispositivo di protezione FI (RCD) I Δ n = 30mA. Zona ② come minimo sistema di protezione IP X4. Zona ② non sono autorizzate le prese di corrente.

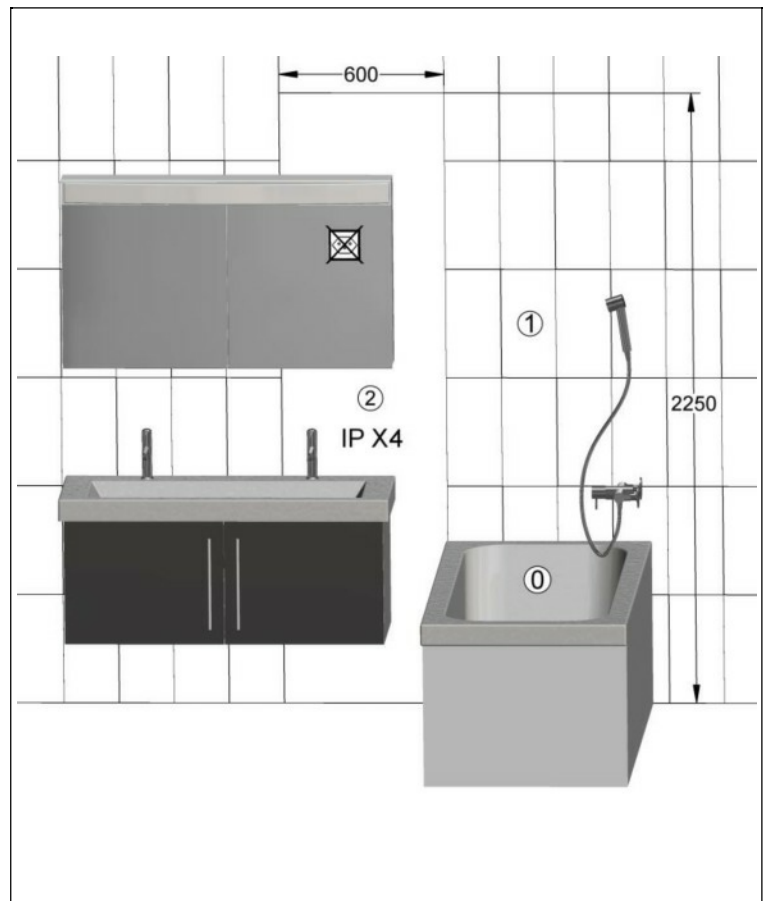

Alle Masse sind in mm angegeben. / Toutes les mesures sont indiquées en mm. / Tutte le misure sono indicate in mm.

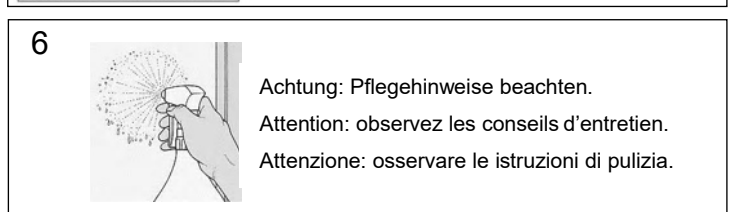
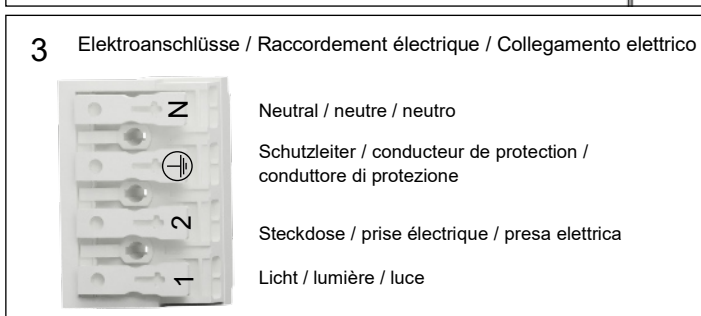
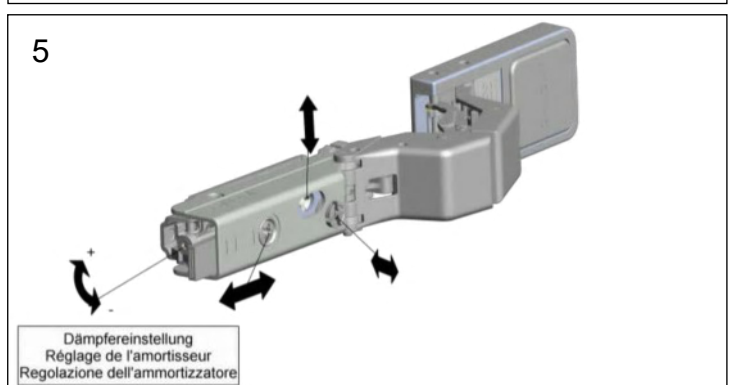
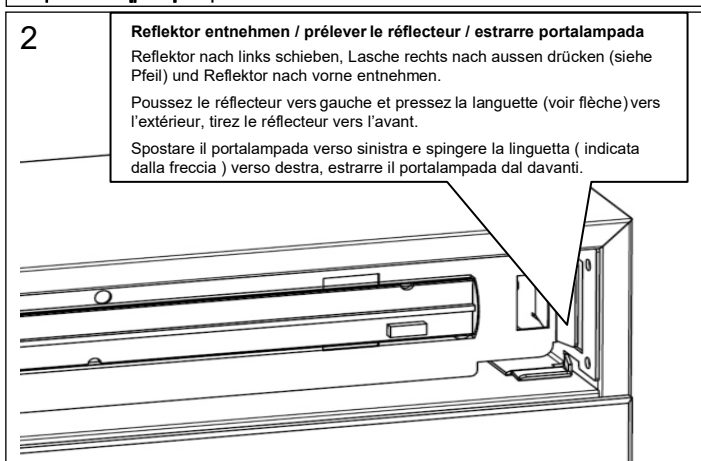
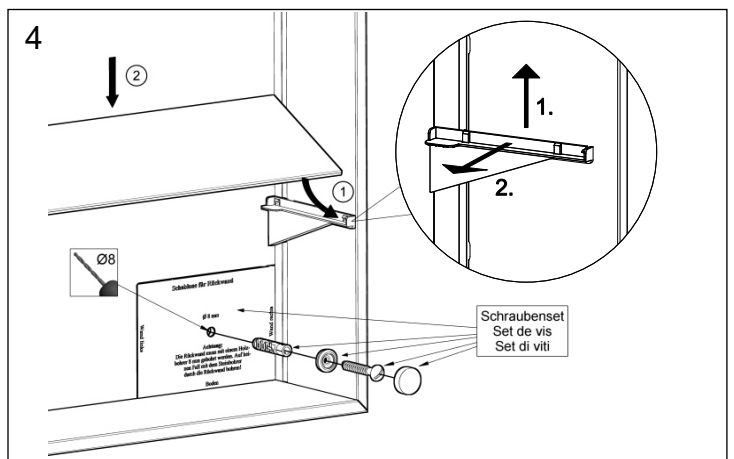
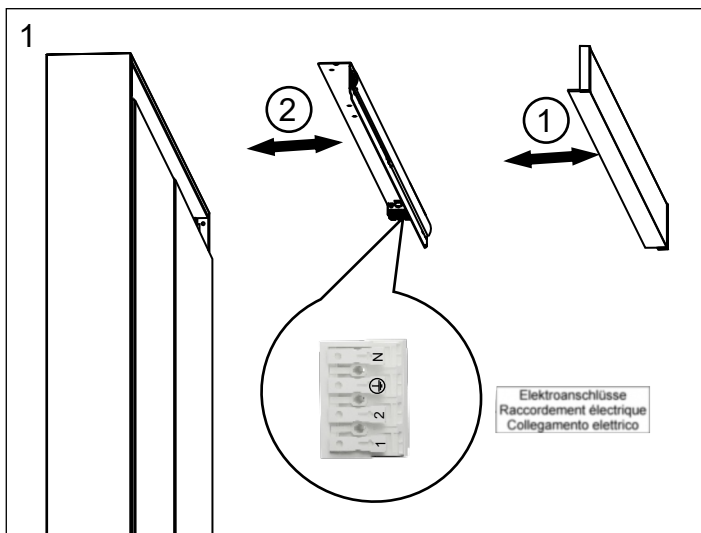
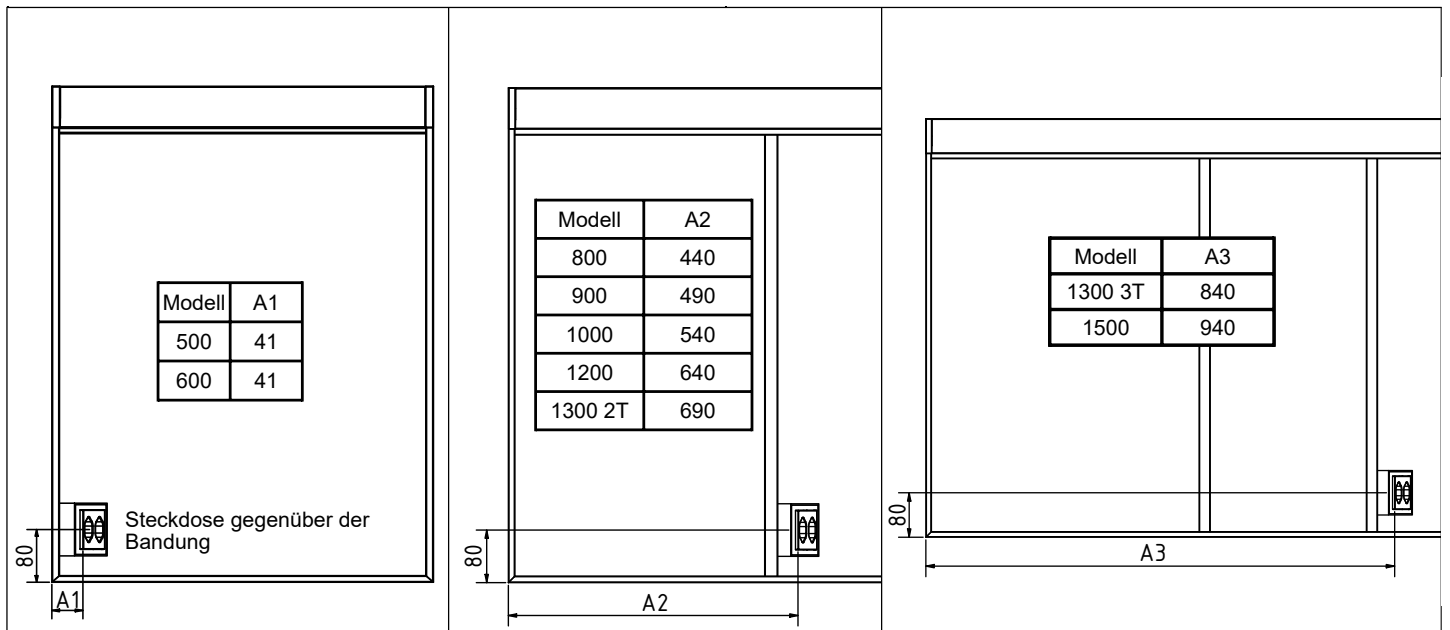

Massskizze / Montageanleitung Wandeinbau Modico Rem.3 LED

Fiche de mesure / Instruction de montage pour l'encastrement Modico Rem.3 LED

Istruzione di montaggio ad incasso Modico Rem.3 LED

690309 Keller Art. Nr. 110403173	Modico Rem.3 LED 500/1T/BL Modico Rem.3 LED 500/1P/CD Modico Rem.3 LED 500/1P/CS	690315 Keller Art. Nr. 110403413	Modico Rem.3 LED 1000/2T Modico Rem.3 LED 1000/2P Modico Rem.3 LED 1000/2P
690310 Keller Art. Nr. 110403183	Modico Rem.3 LED 500/1T/BR Modico Rem.3 LED 500/1P/CD Modico Rem.3 LED 500/1P/CD	690316 Keller Art. Nr. 110403513	Modico Rem.3 LED 1200/2T Modico Rem.3 LED 1200/2P Modico Rem.3 LED 1200/2P
690311 Keller Art. Nr. 110403013	Modico Rem.3 LED 600/1T/BL Modico Rem.3 LED 600/1P/CG Modico Rem.3 LED 600/1P/CS	690317 Keller Art. Nr. 110403733	Modico Rem.3 LED 1300/2T Modico Rem.3 LED 1300/2P Modico Rem.3 LED 1300/2P
690312 Keller Art. Nr. 110403023	Modico Rem.3 LED 600/1T/BR Modico Rem.3 LED 600/1P/CD Modico Rem.3 LED 600/1P/CD	690319 Keller Art. Nr. 110403723	Modico Rem.3 LED 1300/3T Modico Rem.3 LED 1300/3T Modico Rem.3 LED 1300/3T
690313 Keller Art. Nr. 110403073	Modico Rem.3 LED 800/2T Modico Rem.3 LED 800/2P Modico Rem.3 LED 800/2P	690318 Keller Art. Nr. 110403813	Modico Rem.3 LED 1500/3T Modico Rem.3 LED 1500/3T Modico Rem.3 LED 1500/3T
690314 Keller Art. Nr. 110403313	Modico Rem.3 LED 900/2T Modico Rem.3 LED 900/2P Modico Rem.3 LED 900/2P		

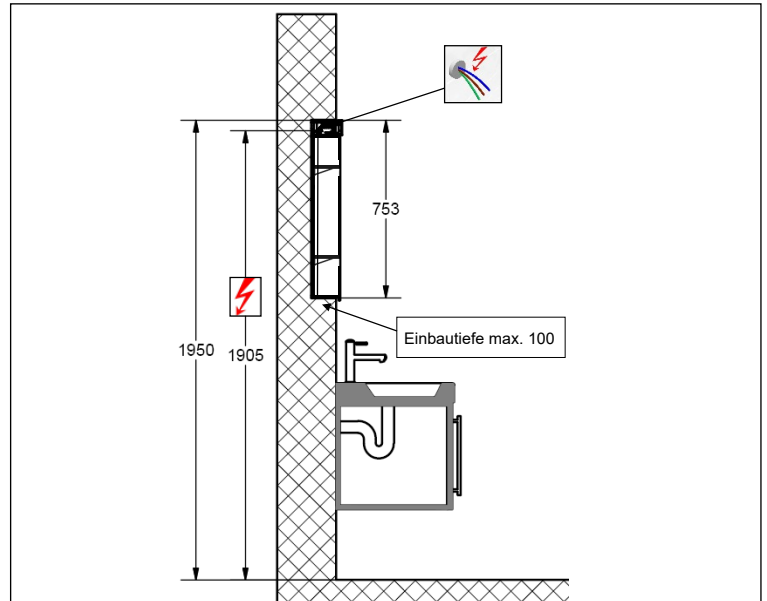
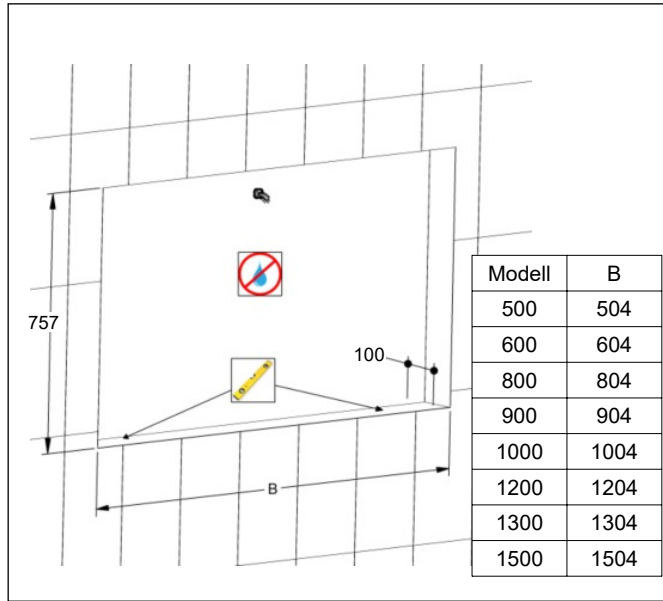
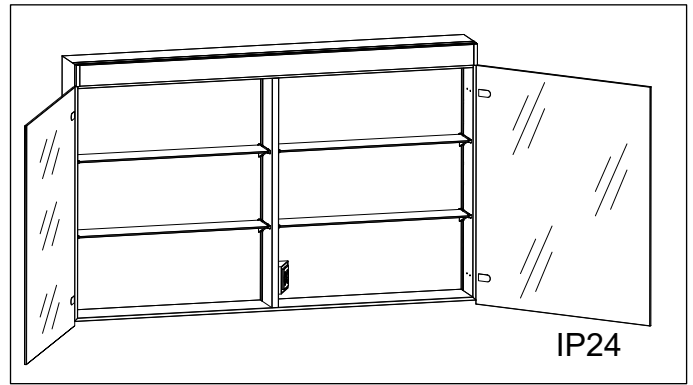

Die Montage des Spiegelschranks muss durch einen Fachmann im Sanitärbereich erfolgen. Arbeiten an den elektrischen Installationen dürfen nur von autorisierten Fachleuten nach den örtlichen Vorschriften ausgeführt werden. Für nicht fachgerechte Installation wird jegliche Haftung abgelehnt. Räume mit Badewanne ① oder Dusche ② müssen mit einer FI-Schutzeinrichtung (RCD) I Δ n = 30mA gesichert sein. Bereich ② mindestens Schutzart IP X4. Bereich ② keine Steckdosen.

Le montage de l'armoire de toilette doit être effectué par un spécialiste autorisé en équipement sanitaire. Les travaux à l'installation électrique ne doivent pas être effectués que par des spécialistes autorisés selon les prescriptions locales. Si l'installation n'est pas faite par un expert nous déclinons toute responsabilité. Locaux avec baignoire ① ou douche ② doivent être protégés par un dispositif de protection FI (RCD) I Δ n = 30mA. Volume ② mind. degré de protection IP X4. Volume ② des prises électriques ne sont pas permises.

Il montaggio dell'armadietto da bagno deve essere eseguito da personale autorizzato del settore impianti sanitari. L'installazione elettrica deve essere eseguita da personale autorizzato secondo le norme vigenti del posto. Se l'installazione non viene eseguita dal personale autorizzato decliniamo ogni responsabilità. Ambienti con vasca da bagno ① o doccia ② devono essere protetti con un dispositivo di protezione FI (RCD) I Δ n = 30mA. Zona ② come minimo sistema di protezione IP X4. Zona ② non sono autorizzate le prese di corrente.

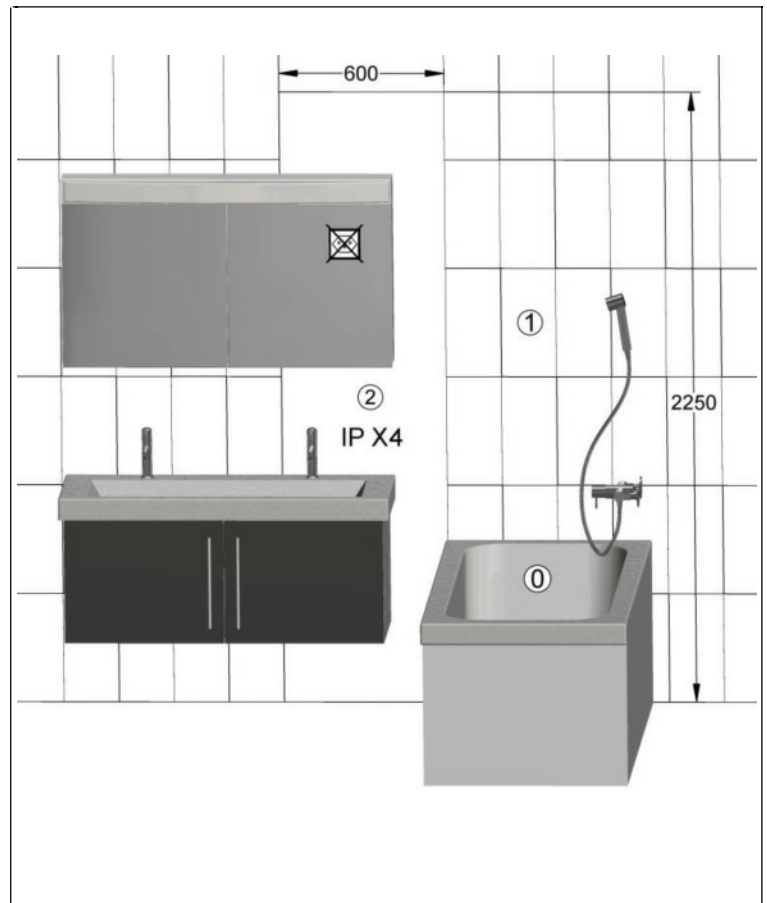

Alle Masse sind in mm angegeben. / Toutes les mesures sont indiquées en mm. / Tutte le misure sono indicate in mm.

